

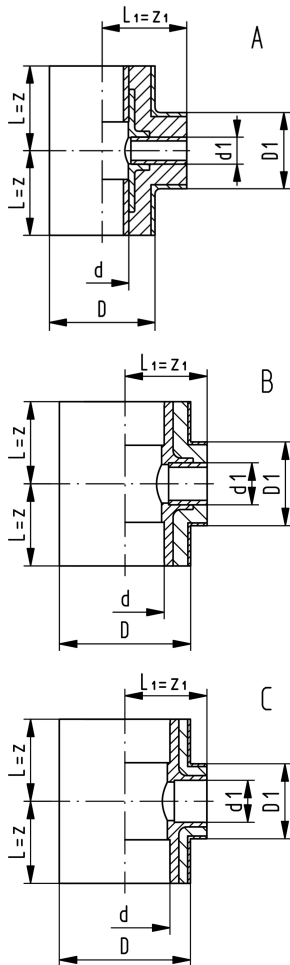

Tee 90° reduced pre-insulated ABS metric

Model:

- Insulation made from PUR
- Outer jacket impact resistant. Color: black
- pre-insulated ABS metric



d (mm)	d1 (mm)	D (mm)	D1 (mm)	Type	PN (bar)	Code	Weight (kg)
32	25	90	90	C	10	738 201 038	0.282
40	25	110	90	C	10	738 201 051	0.433
40	32	110	90	C	10	738 201 047	0.460
50	25	110	90	C	10	738 201 092	0.475
50	32	110	90	C	10	738 201 064	0.489
63	25	125	90	C	10	738 201 093	0.668
63	32	125	90	C	10	738 201 078	0.668
63	50	125	110	C	10	738 201 070	0.802
75	40	140	110	A	10	738 201 182	1.091
90	32	160	90	C	10	738 201 043	1.495
90	63	160	125	C	10	738 201 046	1.597
110	32	180	90	B	10	738 201 144	1.783
110	50	180	110	B	10	738 201 136	1.841
140	50	225	110	B	10	738 201 148	3.229
140	75	225	140	B	10	738 201 149	3.342
160	110	250	180	B	10	738 201 152	4.885
200	110	280	180	C	10	738 201 153	7.799
225	110	315	180	C	10	738 201 156	9.237
225	160	315	250	C	10	738 201 157	9.968

d (mm)	d1 (mm)	z (mm)	z1 (mm)	required Nipple	Closest inch (inch)
32	25	80	80	1x738901607; 2x738901608	1 - 3/4
40	25	90	90	1x738901607; 2x738901609	1 1/4 - 3/4
40	32	90	90	1x738901608; 2x738901609	1 1/4 - 1
50	25	90	90	1x738901607; 2x738901610	1 1/2 - 3/4
50	32	90	90	1x738901608; 2x738901610	1 1/2 - 1
63	25	100	100	1x738901607; 2x738901611	2 - 3/4
63	32	100	100	1x738901608; 2x738901611	2 - 1
63	50	100	100	1x738901610; 2x738901611	2 - 1 1/4
75	40	115	110	1x738901109; 2x738901112	2 1/2 - 1 1/4
90	32	140	140	1x738901608; 2x738901613	3 - 1
90	63	140	140	1x738901611; 2x738901613	3 - 2
110	32	117	130	1x738901108; 2x738901614	4 - 1
110	50	117	130	1x738901110; 2x738901614	4 - 1 1/2
140	50	147	153	1x738901110; 2x738901616	5 - 1 1/2
140	75	147	153	1x738901112; 2x738901616	5 - 2 1/2
160	110	167	165	1x738901114; 2x738901617	6 - 4
200	110	213	193	1x738901614; 2x738901619	8 - 4
225	110	239	206	1x738901614; 2x738901620	8 - 4
225	160	239	206	1x738901617; 2x738901620	8 - 6

The technical data are not binding. They neither constitute expressly warranted characteristics nor guaranteed properties nor a guaranteed durability. They are subject to modification. Our General Terms of Sale apply.

Georg Fischer Piping Systems Ltd, Postfach, CH-8201 Schaffhausen/Switzerland
Phone +41 -(0)52-631 1111

Datasheet

valid from: 11/29/15



e-mail: info.ps@georgfischer.com

Internet: <http://www.gfps.com>