

ecoFIT reducer SDR11

Model:

- Material: PE100
- Conventional butt-welding according to DVS 2207
- IR = Infrared-(IR Plus) compatible. Choose fusion parameters: PE100
- Up to d 315 injection moulded, above machined

d	d1	FM	Code	Weight	PF	L	L1	L2	e	e1
(mm)	(mm)			(kg)		(mm)	(mm)	(mm)	(mm)	(mm)
25	20	IR	753 908 637	0.008	2 68 240 011	50	20	18	2.3	1.9
32	20	IR	753 908 642	0.010	2 68 240 011	50	20	18	2.9	1.9
32	25	IR	753 908 641	0.006	2 68 240 011	50	20	18	2.9	2.3
40	20	IR	753 908 648	0.017	2 68 240 011	58	20	20	3.7	1.9
40	25	IR	753 908 647	0.017	2 68 240 011	55	20	18	3.7	2.3
40	32	IR	753 908 646	0.019	2 68 240 011	55	20	18	3.7	2.9
50	25	IR	753 908 654	0.025	2 68 240 011	60	20	18	4.6	2.3
50	32	IR	753 908 653	0.026	2 68 240 011	60	20	18	4.6	2.9
50	40	IR	753 908 652	0.032	2 68 240 011	60	20	18	4.6	3.7
63	32	IR	753 908 660	0.046	2 68 240 011	65	20	18	5.8	2.9
63	40	IR	753 908 659	0.051	2 68 240 011	65	20	18	5.8	3.7
63	50	IR	753 908 658	0.056	2 68 240 011	65	20	18	5.8	4.6
75	40	IR	753 908 666	0.070	2 68 240 011	68	20	20	6.8	3.7
75	50	IR	753 908 665	0.074	2 68 240 011	65	20	18	6.8	4.6
75	63	IR	753 908 664	0.081	2 68 240 011	65	20	18	6.8	5.8
90	63	IR	753 908 671	0.125	2 68 240 011	75	21	17	8.2	5.8
90	75	IR	753 908 670	0.132	2 68 240 011	75	22	17	8.2	6.8
110	75	IR	753 908 677	0.219	2 68 240 011	90	28	17	10.0	6.8
110	90	IR	753 908 676	0.240	2 68 240 011	90	28	20	10.0	8.2
125	110	IR	753 908 680	0.350	2 68 240 005	100	32	26	11.4	10.0
140	110	IR	753 908 685	0.437	2 68 240 005	110	35	28	12.7	10.0
140	125	IR	753 908 684	0.474	2 68 240 005	110	35	28	12.7	11.4
160	110	IR	753 908 690	0.612	2 68 240 005	120	40	25	14.6	10.0
160	140	IR	753 908 688	0.674	2 68 240 005	120	40	33	14.6	12.7
180	90	IR	753 908 877	0.678	2 68 240 011	157	45	22	16.4	8.2
180	110	IR	753 908 878	0.991	2 68 240 011	157	45	28	16.4	10.0
180	125	IR	753 908 879	0.528	2 68 240 011	136	45	32	16.4	11.4
180	140	IR	753 908 880	0.963	2 68 240 011	136	45	35	16.4	12.7
180	160	IR	753 908 881	1.094	2 68 240 011	136	45	40	16.4	14.6
200	160	IR	753 908 692	1.247	2 68 240 005	150	50	35	18.2	14.6
200	180	IR	753 908 883	1.419	2 68 240 011	151	50	45	18.2	16.4
225	110	IR	753 908 695	1.559	2 68 240 005	171	55	45	20.5	10.0
225	160	IR	753 908 696	1.643	2 68 240 005	160	55	37	20.5	14.6
225	180	IR	753 908 885	1.999	2 68 240 011	171	55	45	20.5	16.4
225	200	IR	753 908 697	1.844	2 68 240 005	160	55	48	20.5	18.2
250	160		753 908 890	2.416	2 68 240 011	194	60	40	22.7	14.6
250	180		753 900 001	2.513	2 68 240 040	175	60	55	22.7	16.4
250	200		753 900 002	2.450	2 68 240 040	180	60	60	22.7	18.2
250	225		753 908 887	2.766	2 68 240 011	182	60	55	22.7	20.5
280	200		753 900 004	3.540	2 68 240 040	205	70	50	25.4	18.2
280	225		753 908 892	1.943	2 68 240 011	105	30	20	25.4	20.5
280	250		753 908 891	1.802	2 68 240 011	70	30	18	25.4	22.7
315	200		753 900 007	3.996	2 68 240 040	225	80	50	28.6	20.5
315	225		753 908 897	3.491	2 68 240 011	130	30	30	28.6	20.5
315	250		753 908 896	2.379	2 68 240 011	100	30	20	28.6	22.7
315	280		753 908 895	1.684	2 68 240 011	63	30	18	28.6	25.4
355	225		753 900 011	4.700	2 68 240 040	245	90	55	32.3	20.5
355	250		753 900 012	4.400	2 68 240 040	245	90	60	32.3	22.7
355	280		753 900 013	4.100	2 68 240 040	245	90	70	32.3	25.4
355	315		753 900 014	3.700	2 68 240 040	245	90	80	32.3	28.6
400	225		753 900 015	7.963	2 68 240 040	260	95	60	36.4	20.5

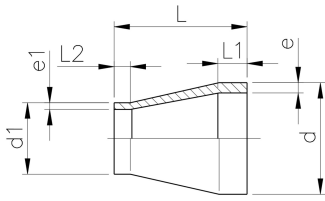

d (mm)	d1 (mm)	FM	Code	Weight (kg)	PF	L (mm)	L1 (mm)	L2 (mm)	e (mm)	e1 (mm)
400	250		753 900 016	6.800	2 68 240 040	260	95	70	36.4	22,7
400	280		753 900 017	6.200	2 68 240 040	260	95	70	36.4	25,4
400	315		753 900 018	10.829	2 68 240 040	260	95	80	36.4	28,6
400	355		753 900 019	4.800	2 68 240 040	260	95	90	36.4	32,3
450	280		753 900 020	9.000	2 68 240 040	230	60	70	40.9	25,4
450	315		753 900 021	8.000	2 68 240 040	230	60	80	40.9	28,6
450	355		753 900 022	7.400	2 68 240 040	230	60	90	40.9	32,3
450	400		753 900 023	6.600	2 68 240 040	230	60	95	40.9	36,4
500	315		753 900 024	12.000	2 68 240 040	230	60	80	45.5	28,6
500	355		753 900 025	10.800	2 68 240 040	230	60	90	45.5	32,3
500	400		753 900 026	10.000	2 68 240 040	230	60	95	45.5	36,4
500	450		753 900 027	8.300	2 68 240 040	200	60	60	45.5	40,9
710	500		753 900 035	24.157	2 68 240 040	190	84	40	64.5	45,4
710	560		753 900 036	21.770	2 68 240 040	170	81	40	64.5	50,8
710	630		753 900 037	17.845	2 68 240 040	140	71	40	64.5	57,2

The technical data are not binding. They neither constitute expressly warranted characteristics nor guaranteed properties nor a guaranteed durability. They are subject to modification. Our General Terms of Sale apply.

Georg Fischer Piping Systems Ltd, Postfach, CH-8201 Schaffhausen/Switzerland

Phone +41 -(0)52-631 1111

e-mail: info.ps@georgfischer.com

Internet: <http://www.gfps.com>