

SYGEF Standard Check valve type 561 With fixed flanges metric

Model:

- Material: PVDF
- Sealing at a minimum water column of 2 m
- Designed for easy installation and removal
- Vibration free even at high flow velocity
- Flow-optimized return cone, double guided
- For vertical installation
- Compact installation length, same as ball valve type 546
- Installation length according to EN 558-1
- Z-length, end connectors and union nuts **not** compatible with type 360
- Connecting dimension: ISO 7005 PN10, EN 1092 PN10, DIN 2501 PN10

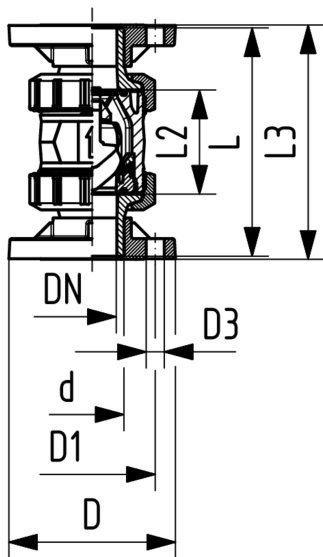

Warning: please make sure the diameter is not reduced through welding beads (Danger of turbulences)

d [mm]	DN [mm]	PN [bar]	kv-value ($\Delta p=1$ bar) [l/min]	FPM Code	SP	Weight [kg]
20	15	16	180	175 561 192	1	0.420
25	20	16	380	175 561 193	1	0.700
32	25	16	460	175 561 194	1	0.860
40	32	16	850	175 561 195	1	1.430
50	40	16	1080	175 561 196	1	1.940
63	50	16	1670	175 561 197	1	3.160

d [mm]	D [mm]	D1 [mm]	D3 [mm]	L [mm]	L2 [mm]	L3 [mm]	closest inch [inch]
20	93	65	14	120	56	130	1/2
25	103	75	14	140	65	150	3/4
32	115	85	14	150	71	160	1
40	137	100	18	170	85	180	1 1/4
50	147	110	18	190	89	200	1 1/2
63	162	125	18	220	101	230	2

The technical data are not binding. They neither constitute expressly warranted characteristics nor guaranteed properties nor a guaranteed durability. They are subject to modification. Our General Terms of Sale apply.

Georg Fischer Piping Systems Ltd, Postfach, CH-8201 Schaffhausen/Switzerland
 Phone +41 -(0)52-631 1111
 e-mail: info.ps@georgfischer.com
 Internet: <http://www.gfps.com>