

SYGEF Standard reducer SDR33/PN10

Model:

- Material: PVDF

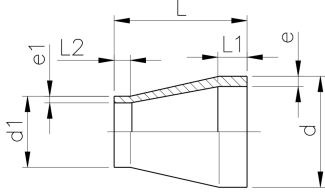

d - d1 [mm]	FM	PN [bar]	SDR	Code	Weight [kg]	e [mm]	e1 [mm]	L [mm]	L1 [mm]	L2 [mm]
90 - 63	BCF, IR	10	33 - 21	735 908 551	0.124	2.8	3.0	75	25	30
110 - 63	BCF, IR	10	33 - 21	735 908 553	0.196	3.4	3.0	90	30	30
110 - 90	BCF, IR	10	33 - 33	735 908 555	0.197	3.4	2.8	90	30	35
125 - 110	IR	10	33 - 21	735 908 580	0.270	3.9	5.3	100	35	40
140 - 110	IR	10	33 - 21	735 908 585	0.385	4.3	5.3	110	40	40
140 - 125	IR	10	33 - 33	735 908 584	0.340	4.3	3.9	110	40	40
160 - 110	IR	10	33 - 33	735 908 561	0.516	4.9	3.4	120	40	40
160 - 110	IR	10	33 - 21	735 908 590	0.573	4.9	5.3	120	40	40
160 - 140	IR	10	33 - 33	735 908 588	0.568	4.9	4.3	120	40	40
200 - 160	IR	10	33 - 33	735 908 592	0.830	6.2	4.9	145	50	40
225 - 110	IR	10	33 - 33	735 908 566	1.120	6.9	3.4	160	55	35
225 - 110	IR	10	33 - 21	735 908 595	0.940	6.9	5.3	160	55	35
225 - 160	IR	10	33 - 33	735 908 596	1.140	6.9	4.9	160	55	40
225 - 200	IR	10	33 - 33	735 908 597	1.200	6.9	6.2	160	55	50

The technical data are not binding. They neither constitute expressly warranted characteristics nor guaranteed properties nor a guaranteed durability. They are subject to modification. Our General Terms of Sale apply.

Georg Fischer Piping Systems Ltd, Postfach, CH-8201 Schaffhausen/Switzerland
 Phone +41 -(0)52-631 1111
 e-mail: info.ps@georgfischer.com
 Internet: <http://www.gfps.com>